



NORTH DUKE STREET
30,000 VPD

FOUNDRY
COMMERCIAL

3300 NORTH DUKE STREET
DURHAM, NORTH CAROLINA 27704

±2.14 AC FOR LEASE

3300 NORTH DUKE STREET

±2.14 AC FOR LEASE



SITE OVERVIEW

- Heavily travelled corridor with over 30,000 VPD
- Excellent access and visibility
- Located near Duke Regional Hospital
- New Sheetz gas station
- Strong daytime and evening population

SITE FEATURES

SIZE	2.14 AC
UTILITIES	MUNICIPAL WATER AND SEWER
RATE	CALL FOR PRICING

DEMOGRAPHICS	1 MILE	3 MILES	5 MILES
2023 POPULATION	8,518	65,653	147,211
2028 PROJECTED POPULATION	8,901	69,040	154,400
AVG. HOUSEHOLD INCOME	\$68,402	\$100,385	\$98,351

TRAFFIC COUNTS

NORTH DUKE STREET	30,000 VPD
NORTH ROXBORO STREET	17,500 VPD

For more information, please contact:

JAMES MATTOX
(919) 576 2696
james.mattox@foundrycommercial.com

ROSS DIACHENKO
(919) 576 2682
ross.diachenko@foundrycommercial.com

FOUNDRY
COMMERCIAL

2301 Sugar Bush Road, Suite 220
Raleigh, NC 27612

foundrycommercial.com

Although the information contained herein was provided by sources believed to be reliable, Foundry Commercial makes no representation, expressed or implied, as to its accuracy and said information is subject to errors, omissions or changes.

3300 NORTH DUKE STREET

±2.14 AC FOR LEASE

LOCATION OVERVIEW



For more information, please contact:

JAMES MATTOX
(919) 576 2696
james.mattox@foundrycommercial.com

ROSS DIACHENKO
(919) 576 2682
ross.diachenko@foundrycommercial.com

FOUNDRY
COMMERCIAL

2301 Sugar Bush Road, Suite 220
Raleigh, NC 27612

foundrycommercial.com

Although the information contained herein was provided by sources believed to be reliable, Foundry Commercial makes no representation, expressed or implied, as to its accuracy and said information is subject to errors, omissions or changes.

3300 NORTH DUKE STREET

±2.14 AC FOR LEASE

RETAIL OVERVIEW



For more information, please contact:

JAMES MATTOX

(919) 576 2696

james.mattox@foundrycommercial.com

ROSS DIACHENKO

(919) 576 2682

ross.diachenko@foundrycommercial.com

FOUNDRY
COMMERCIAL

2301 Sugar Bush Road, Suite 220
Raleigh, NC 27612

foundrycommercial.com

Although the information contained herein was provided by sources believed to be reliable, Foundry Commercial makes no representation, expressed or implied, as to its accuracy and said information is subject to errors, omissions or changes.

3300 NORTH DUKE STREET

±2.14 AC FOR LEASE

CONCEPT PLAN ONE

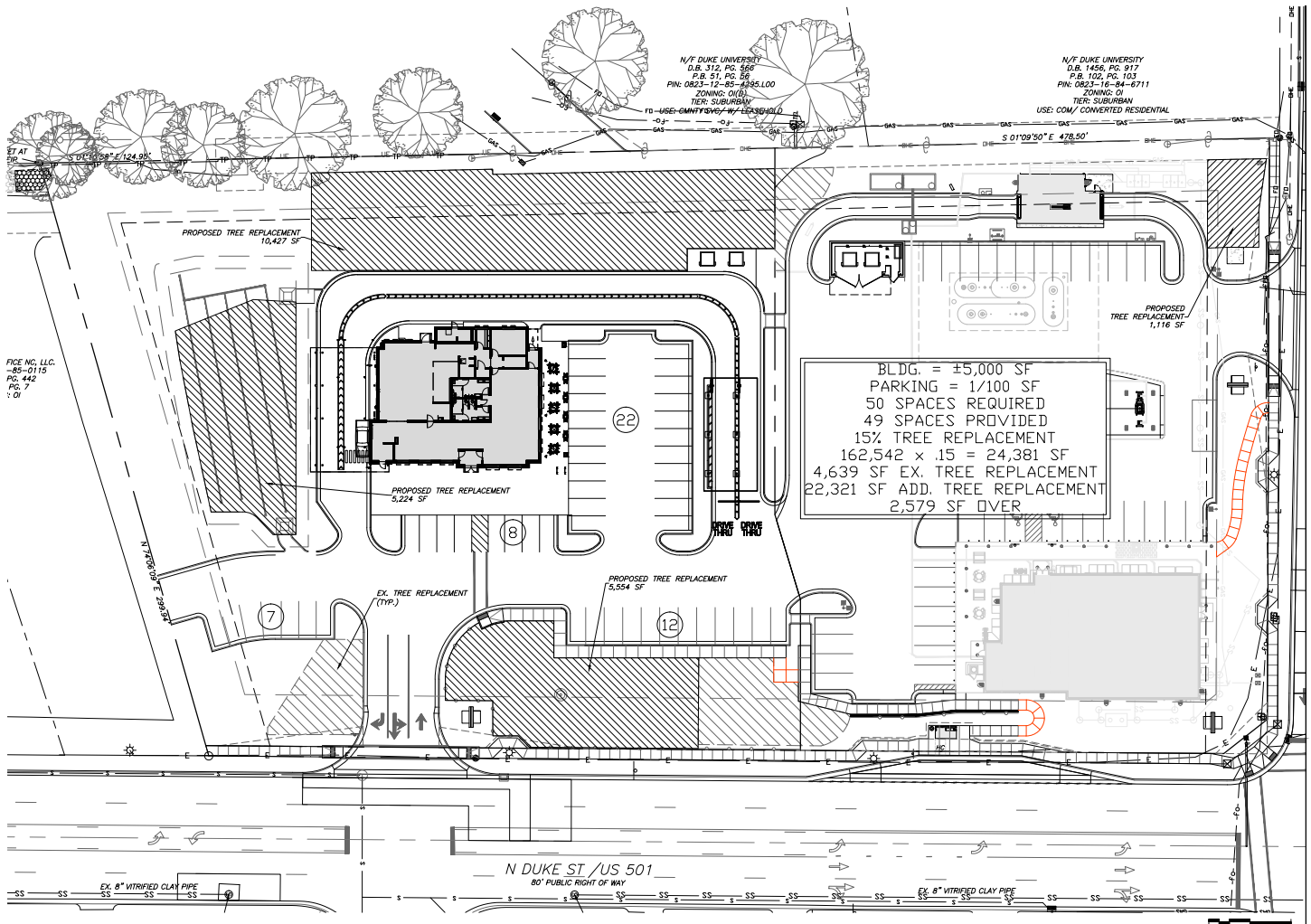

For more information, please contact:

JAMES MATTOX
(919) 576 2696
james.mattox@foundrycommercial.com

ROSS DIACHENKO
(919) 576 2682
ross.diachenko@foundrycommercial.com

FOUNDRY
COMMERCIAL

2301 Sugar Bush Road, Suite 220
Raleigh, NC 27612

foundrycommercial.com

Although the information contained herein was provided by sources believed to be reliable, Foundry Commercial makes no representation, expressed or implied, as to its accuracy and said information is subject to errors, omissions or changes.

3300 NORTH DUKE STREET

±2.14 AC FOR LEASE

CONCEPT PLAN TWO

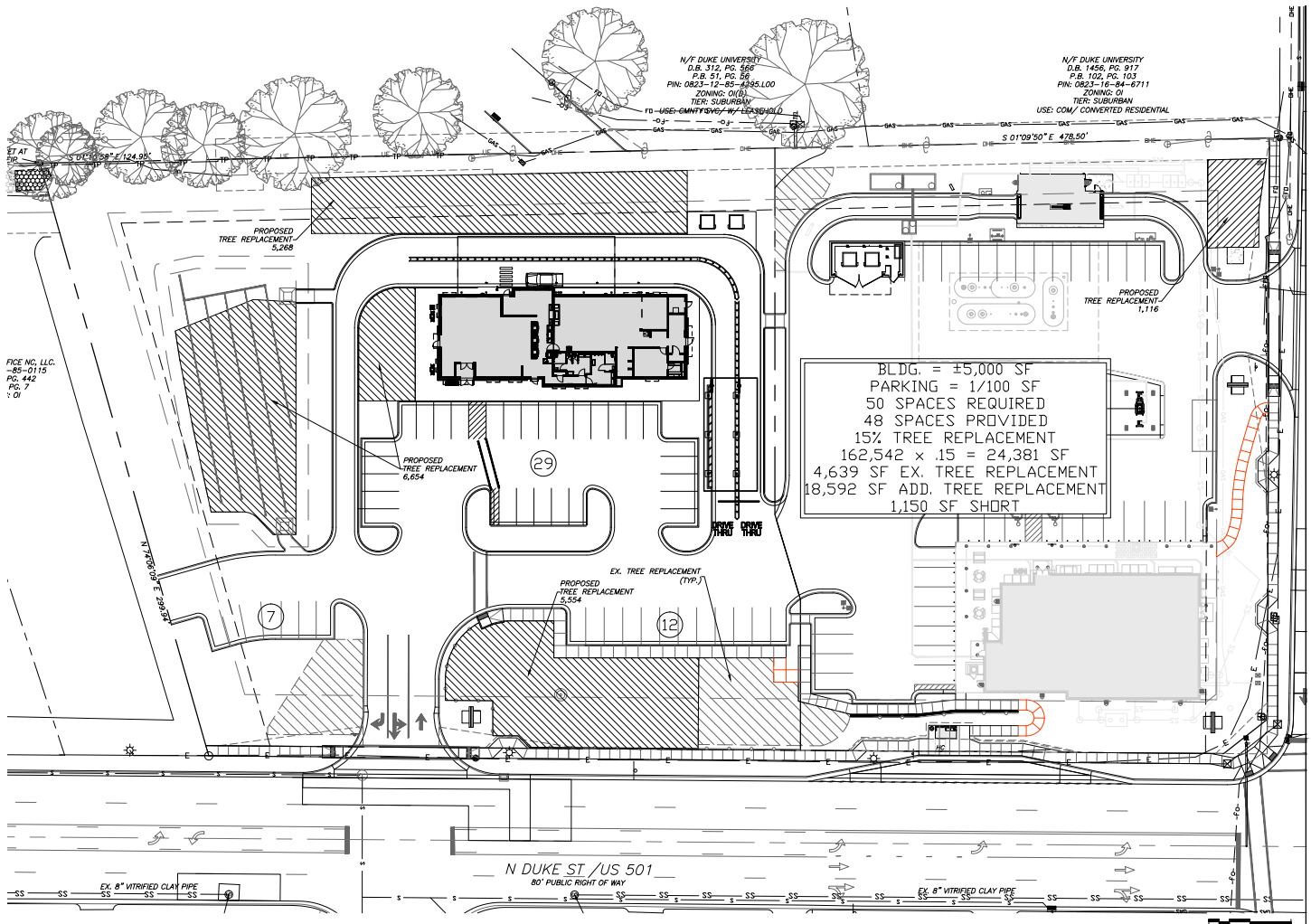

For more information, please contact:

JAMES MATTOX
(919) 576 2696
james.mattox@foundrycommercial.com

ROSS DIACHENKO
(919) 576 2682
ross.diachenko@foundrycommercial.com

FOUNDRY
COMMERCIAL

2301 Sugar Bush Road, Suite 220
Raleigh, NC 27612

foundrycommercial.com

Although the information contained herein was provided by sources believed to be reliable, Foundry Commercial makes no representation, expressed or implied, as to its accuracy and said information is subject to errors, omissions or changes.