



2402 CLARK ST.

18,600 SF FOR LEASE

PROPERTY FEATURES

2402 Clark Street is a multi-tenant, grade level, warehouse building in the heavy industrial pocket of Apopka. The property is located near the intersection of N Orange Blossom Trail and Maitland Blvd (SR 414) which provides convenient access to I-4, and the newly completed 429 Beltway. Recent renovations include fully reconditioned office with new flooring, paint, and large breakroom.



PROPERTY SPECIFICATIONS

ADDRESS	2402 Clark St, Apopka, FL 32703
AVAILABLE SPACE	18,600 +/- SF
OFFICE	4,150 +/- SF
MEZZANINE	4,000 +/- SF
OVERHEAD DOORS	2 - 10' x 10' 1 - 14' x 12'
FIRE SPRINKLERS	Installed
CLEAR HEIGHT	17'8" - 20'5"
PARKING	Fully fenced and secured
AVAILABLE	Now

FOR MORE INFORMATION, PLEASE CONTACT:

JEROD FREELAND | 321.591.5404
Jerod.Freeland@foundrycommercial.com
Licensed Real Estate Broker

CHARLES ATTAWAY | 407.963.4064
Charles.Attaway@foundrycommercial.com
Licensed Real Estate Broker

APOPKA, FL

±18,600 RSF AVAILABLE FOR LEASE

2402 CLARK ST.

FLOOR PLAN

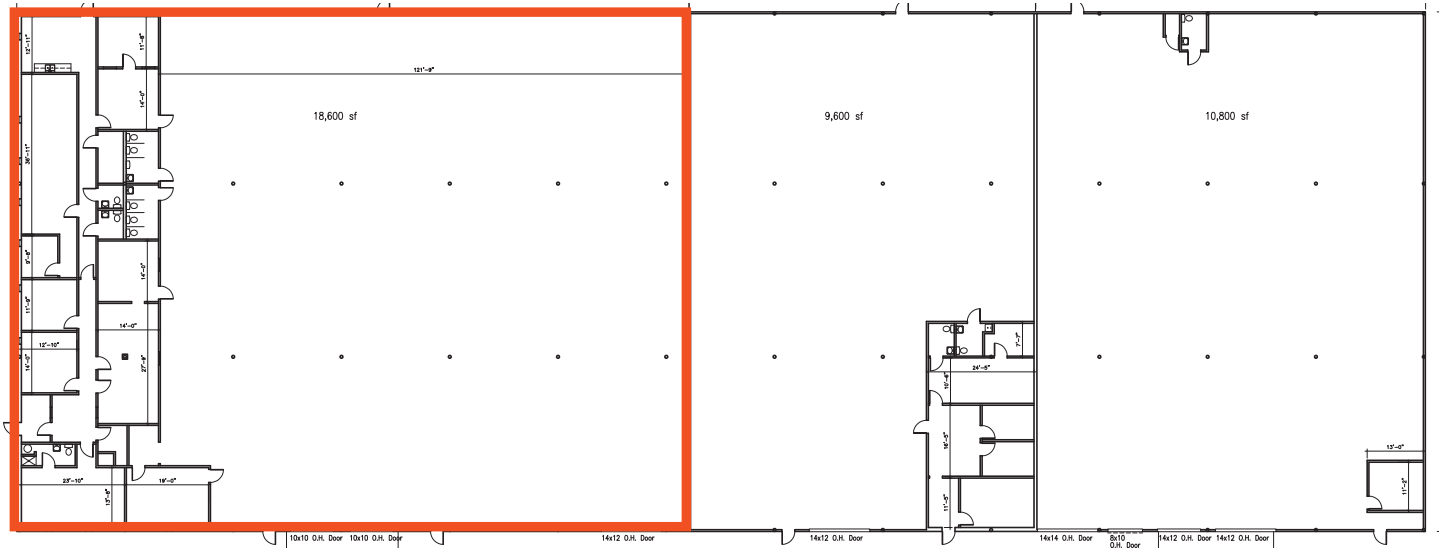

LOCATION

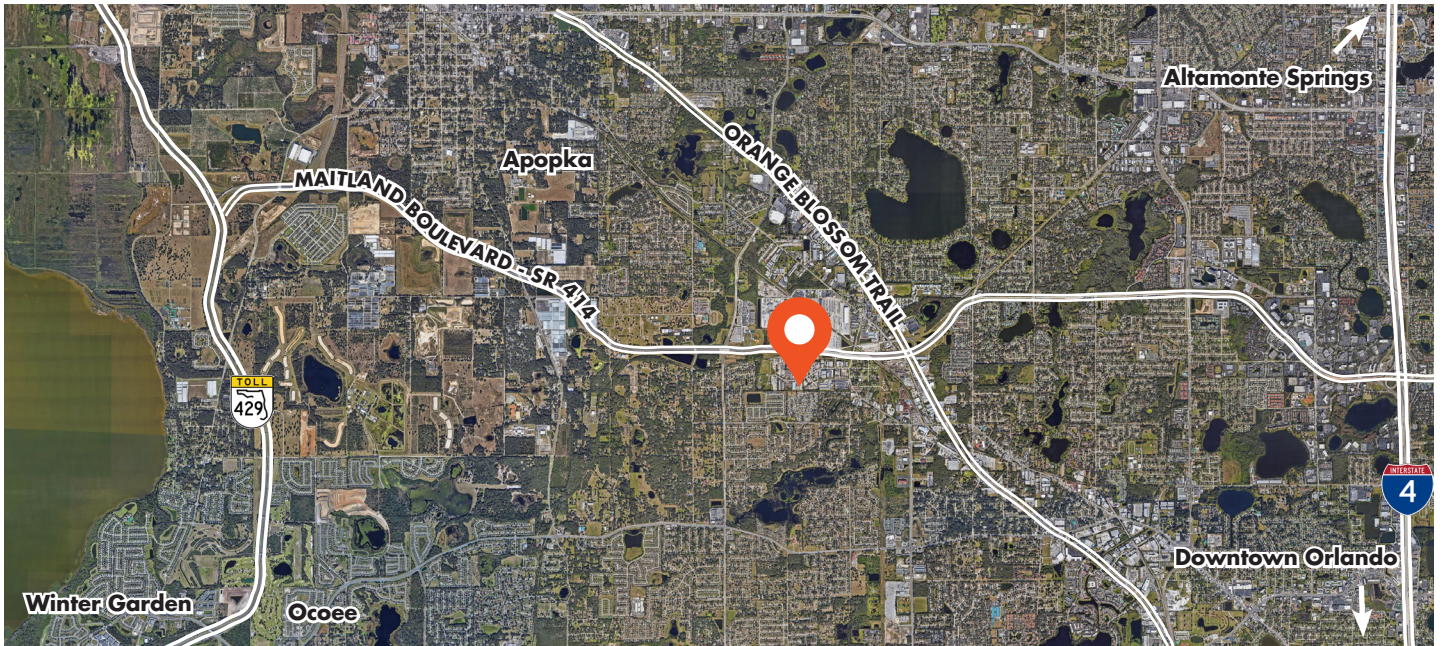

FOR MORE INFORMATION, PLEASE CONTACT:

JEROD FREELAND | 321.591.5404
Jerod.Freeland@foundrycommercial.com
Licensed Real Estate Broker

CHARLES ATTAWAY | 407.963.4064
Charles.Attaway@foundrycommercial.com
Licensed Real Estate Broker

FOUNDRY
COMMERCIAL

Although the information contained herein was provided by sources believed to be reliable, Foundry Commercial makes no representation, expressed or implied, as to its accuracy and said information is subject to errors, omissions or changes.

foundrycommercial.com

APOPKA, FL

±18,600 RSF AVAILABLE FOR LEASE

2402 CLARK ST.

NEWLY RENOVATED OFFICE SPACE



FOR MORE INFORMATION, PLEASE CONTACT:

JEROD FREELAND | 321.591.5404
Jerod.Freeland@foundrycommercial.com
Licensed Real Estate Broker

CHARLES ATTAWAY | 407.963.4064
Charles.Attaway@foundrycommercial.com
Licensed Real Estate Broker

FOUNDRY
COMMERCIAL

Although the information contained herein was provided by sources believed to be reliable, Foundry Commercial makes no representation, expressed or implied, as to its accuracy and said information is subject to errors, omissions or changes.

foundrycommercial.com