

8787 BAYPINE

Lakefront Class A Office Space

← Building Signage



FOUNDRY
COMMERCIAL

PROPERTY FEATURES

- High quality former corporate headquarters
- Full-service rental rate: \$22.75 PRSF
- Lease 49,288 - 231,022 RSF with large efficient floor plans
- Largest block of available office space in suburban Jacksonville
- Strong institutional ownership
- 6.5/1000 parking ratio **in garage** with direct connection to the building on every floor
- Direct signage available on I-95
- Significant renovations planned
- Excellent infrastructure with elevated floor system

Amenities: new common area finishes, outside seating, lakeside boardwalk, abundant restaurants, retail and hotels within 5 minutes.

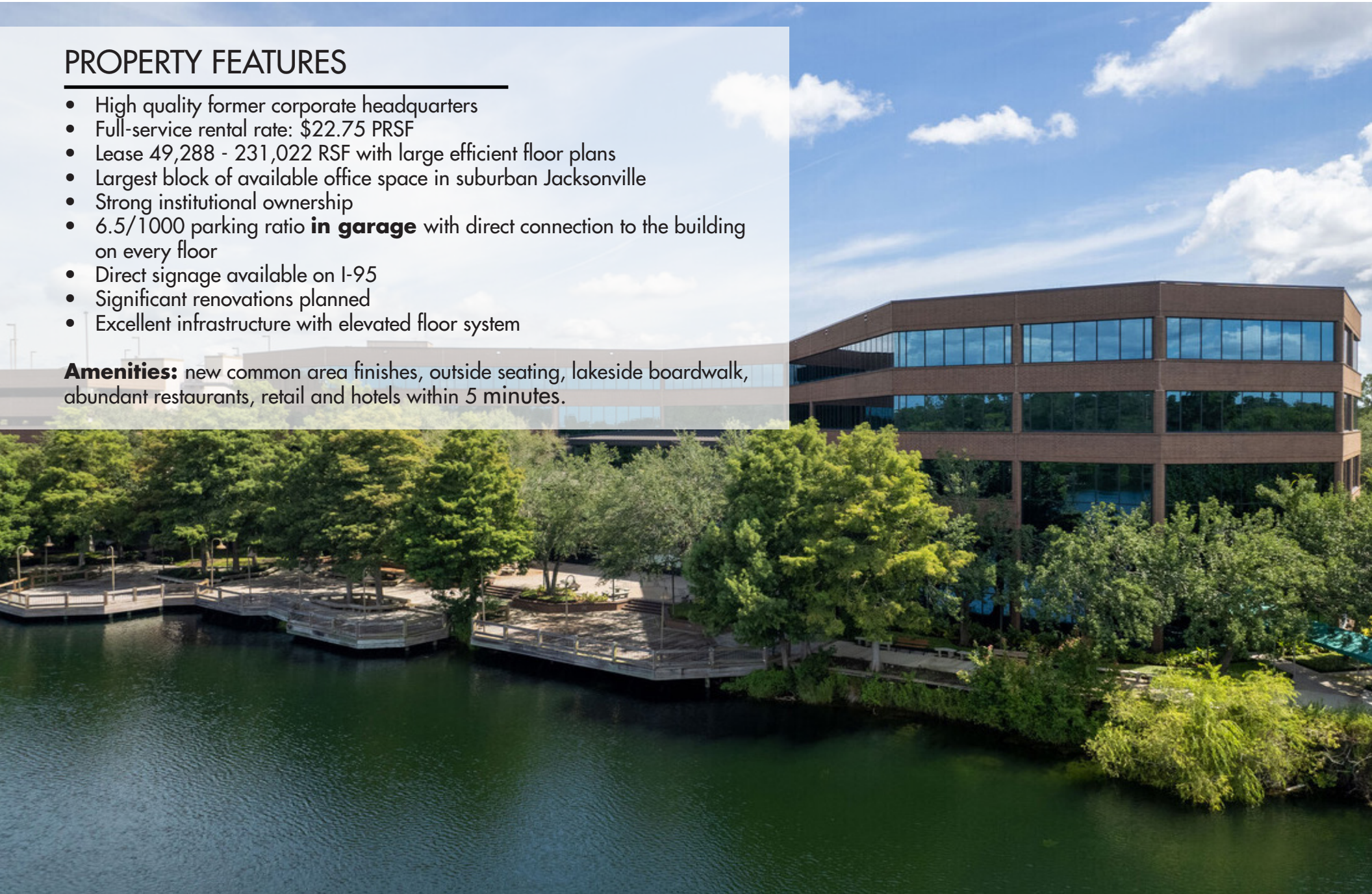

LOBBY



ATRIUM



LAKEFRONT DECK

FIRST FLOOR 35,611 SF AVAILABLE

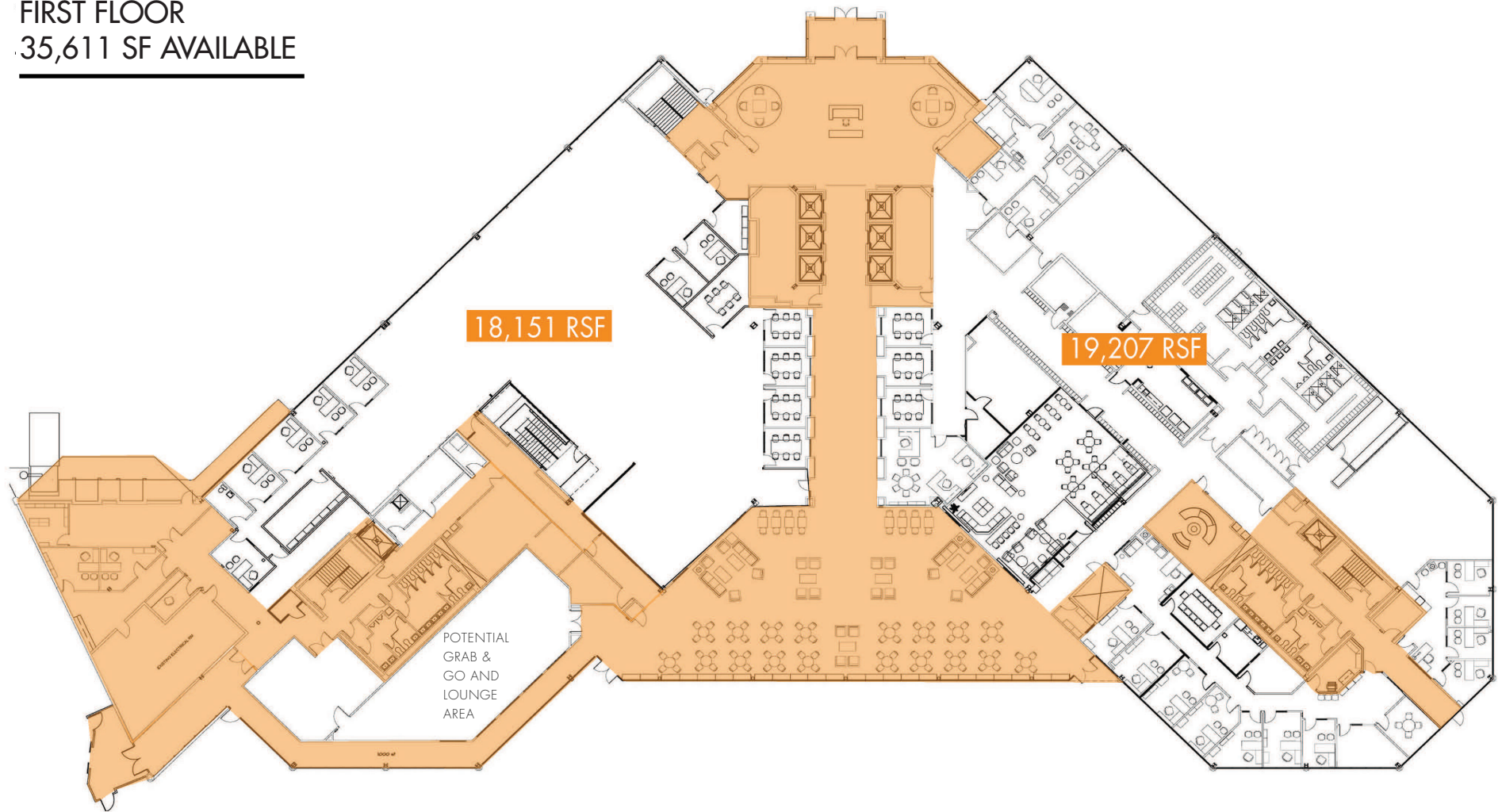

FOR MORE INFORMATION, PLEASE CONTACT:

BRAD CHRISCHILLES | 904.345.2020
Brad.Chrischilles@foundrycommercial.com

SECOND FLOOR
49,288 SF AVAILABLE

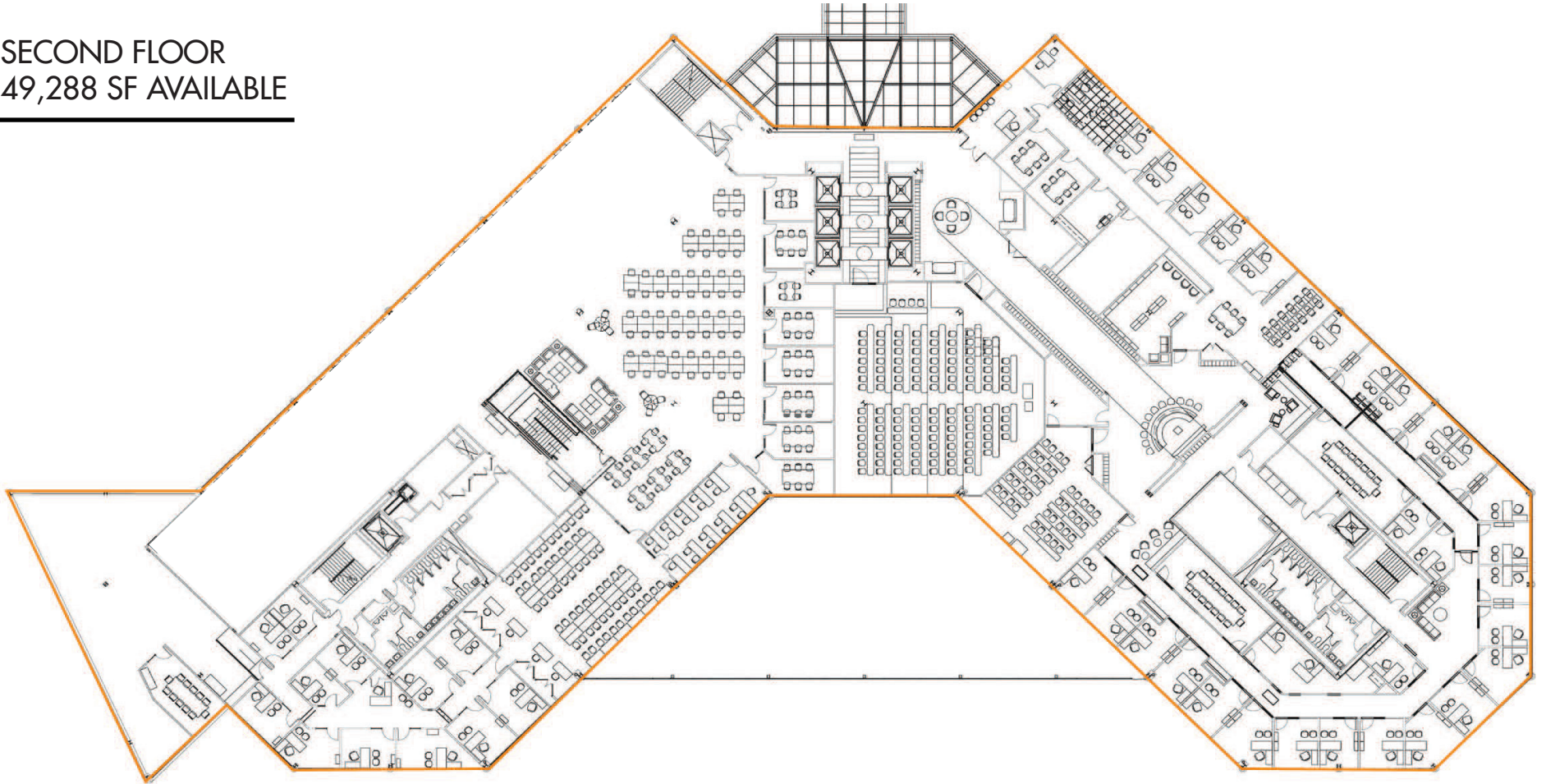

FOR MORE INFORMATION, PLEASE CONTACT:

BRAD CHRISCHILLES | 904.345.2020
Brad.Chrischilles@foundrycommercial.com

THIRD FLOOR
49,519 SF AVAILABLE

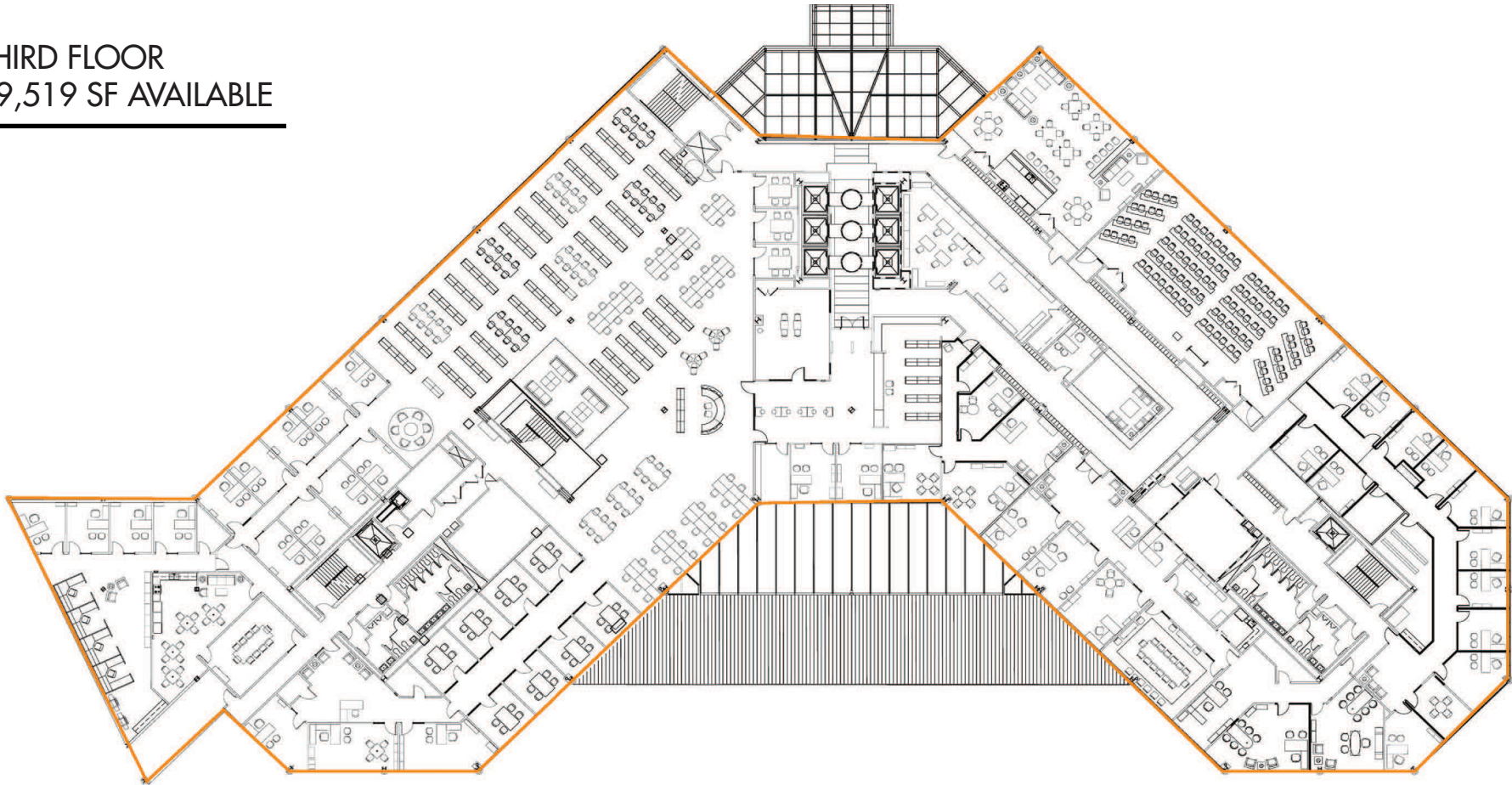

FOR MORE INFORMATION, PLEASE CONTACT:

BRAD CHRISCHILLES | 904.345.2020
Brad.Chrischilles@foundrycommercial.com

FOURTH FLOOR
49,611 SF AVAILABLE

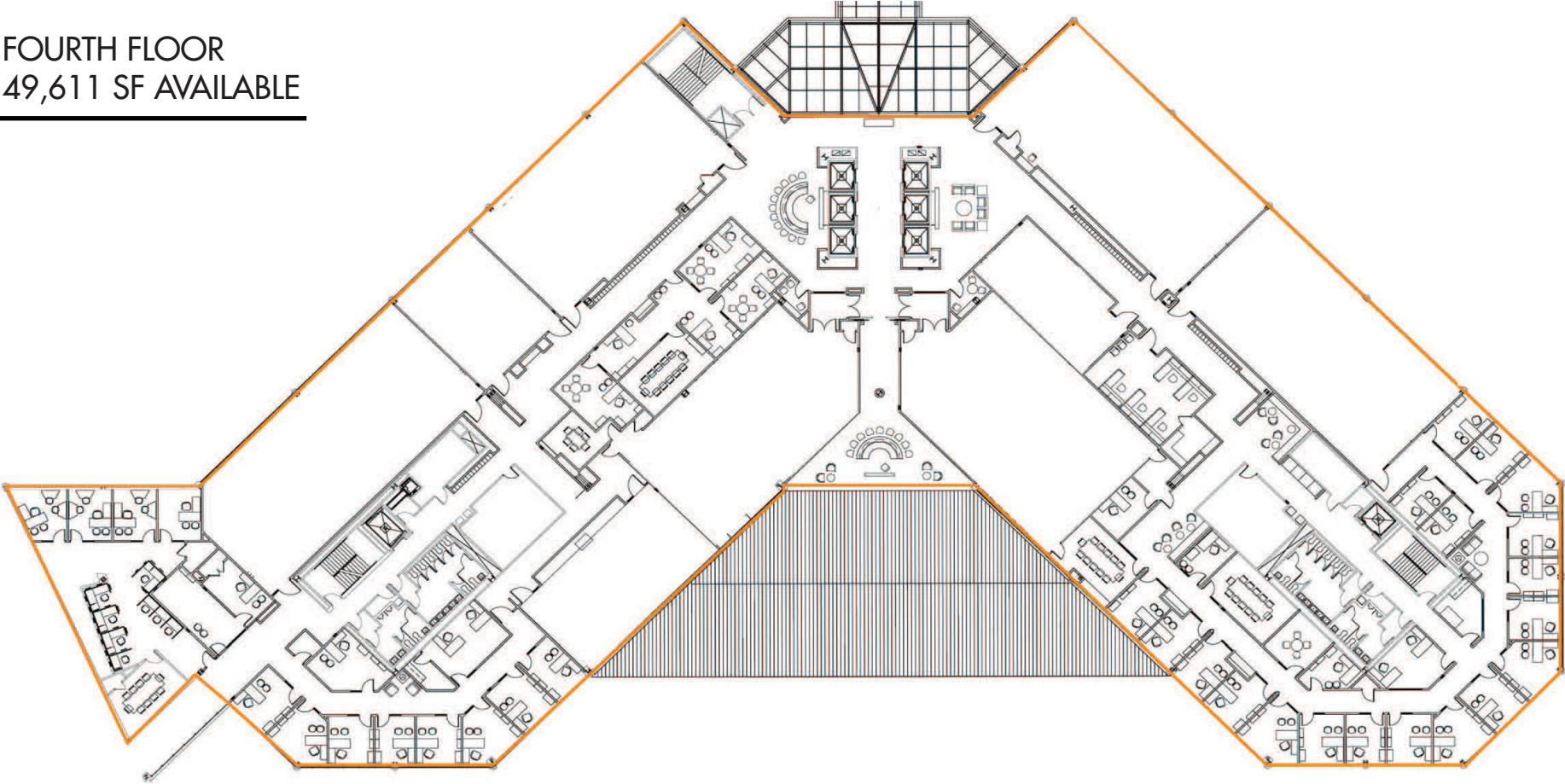

FOR MORE INFORMATION, PLEASE CONTACT:

BRAD CHRISCHILLES | 904.345.2020
Brad.Chrischilles@foundrycommercial.com

FIFTH FLOOR
46,992 SF AVAILABLE

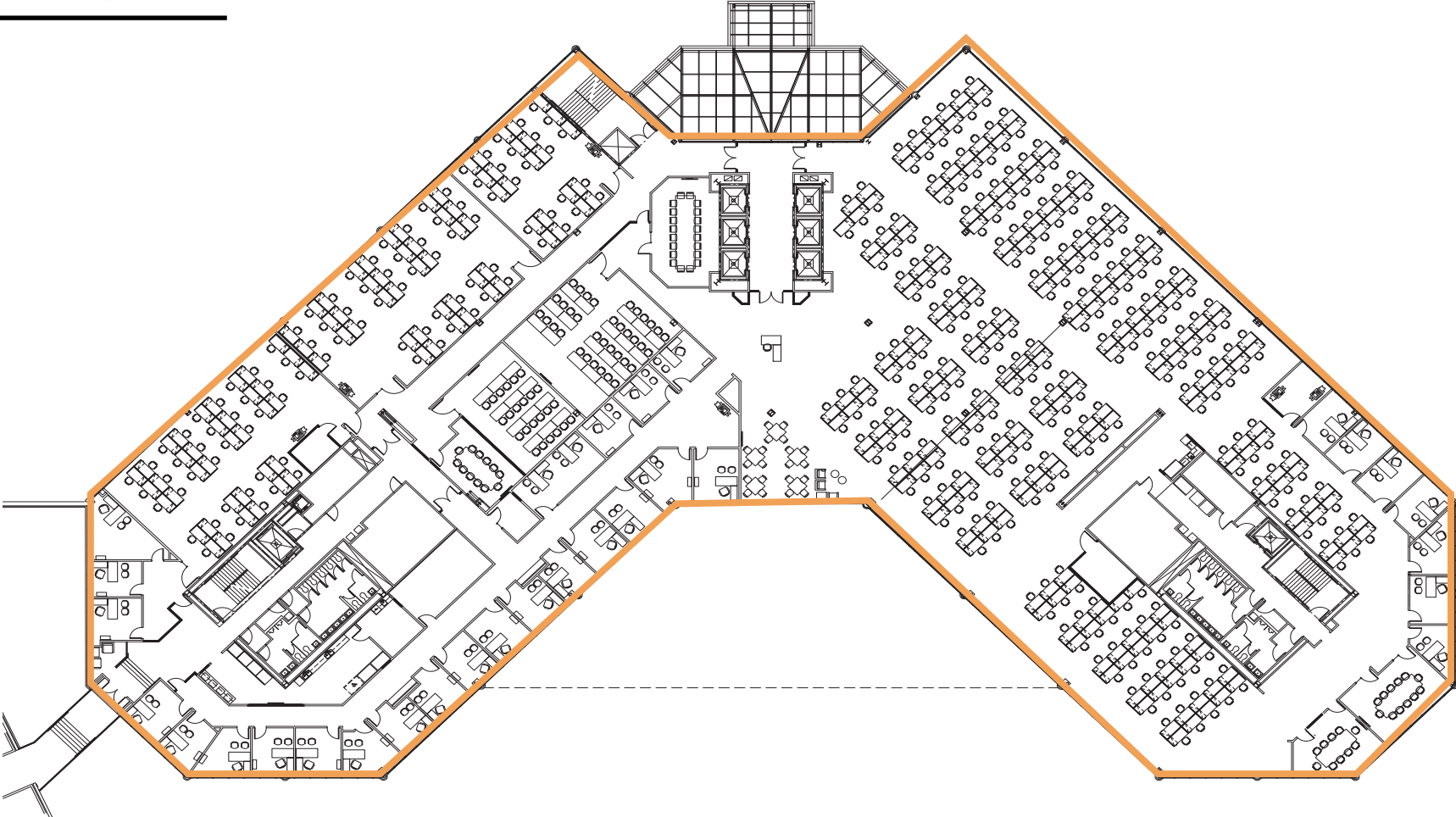

FOR MORE INFORMATION, PLEASE CONTACT:

BRAD CHRISCHILLES | 904.345.2020
Brad.Chrischilles@foundrycommercial.com

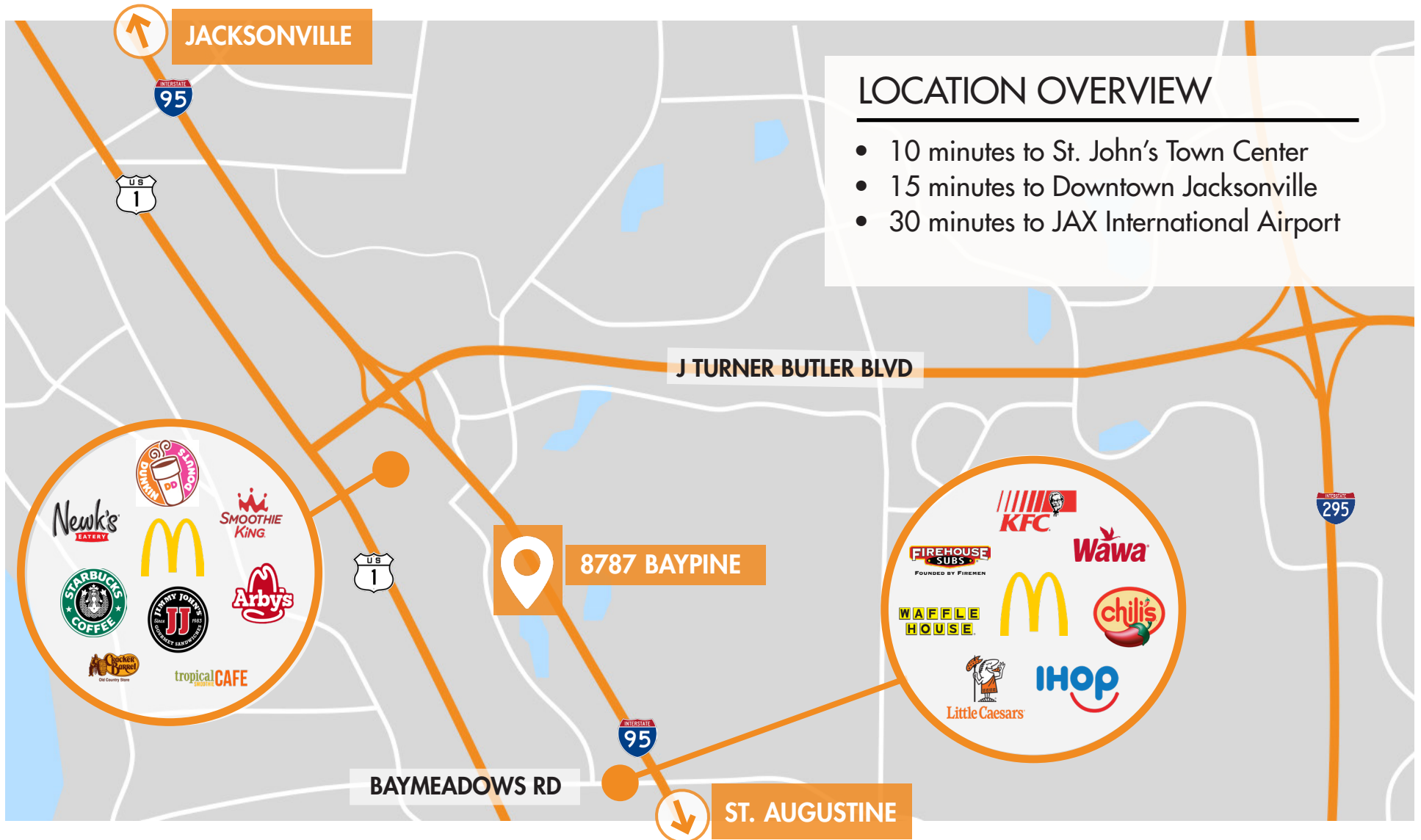

FOR MORE INFORMATION, PLEASE CONTACT:

BRAD CHRISCHILLES | 904.345.2020
Brad.Chrischilles@foundrycommercial.com