

# FOR SUBLEASE

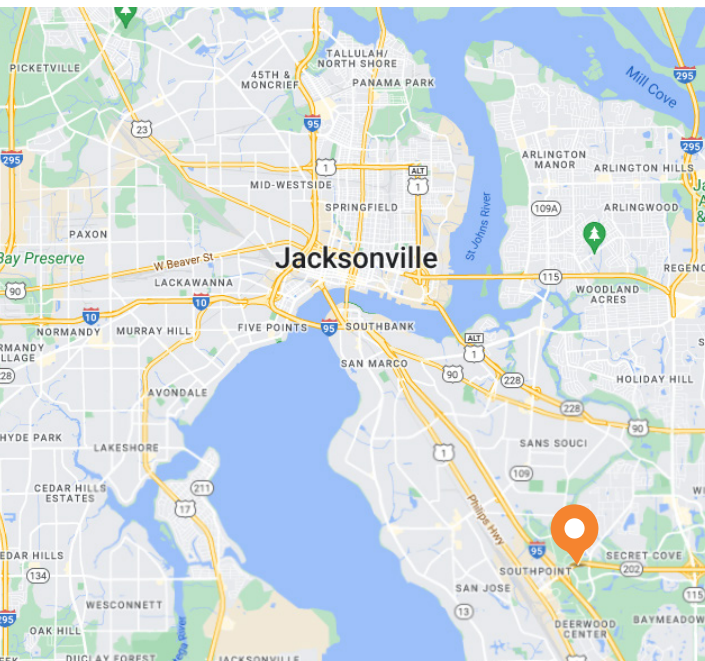

JACKSONVILLE, FLORIDA

**4655 SALISBURY RD  
QUADRANT AT SOUTHPOINT II**



## SPACE SPECIFICATIONS

AVAILABLE	PARTIAL 1ST FLOOR 1,641 RSF
TIMING	IMMEDIATELY
LEASE RATE	\$22.00 PSF
SUBLEASE TERM	6/30/2027

## COMMENTS

- Above-standard fully-furnished sublease ready for immediate occupancy
- Renovated building lobby with seating areas throughout
- On-site property management, fitness center, cafe, outdoor patio seating
- 5/1000 SF parking ratio

### FOR MORE INFORMATION, PLEASE CONTACT:

ANDREW HAWKINS | 904.345.2022

Senior Vice President

Andrew.Hawkins@foundrycommercial.com

Licensed Real Estate Broker

Although the information contained herein was provided by sources believed to be reliable, Foundry Commercial makes no representation, expressed or implied, as to its accuracy and said information is subject to errors, omissions or changes.

**FOUNDRY**  
COMMERCIAL

[foundrycommercial.com](http://foundrycommercial.com)



# QUADRANT AT SOUTHPOINT II

4655 SALISBURY RD

## FLOOR PLAN AND PHOTOS

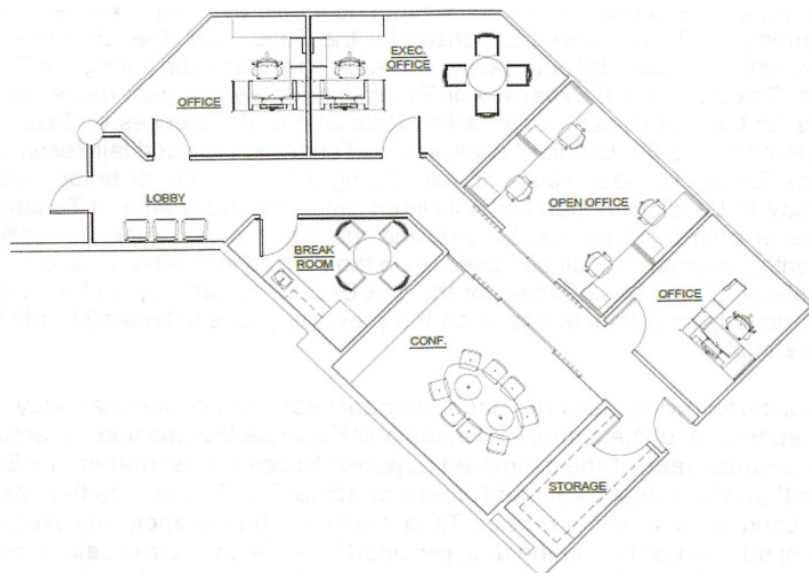

FOR MORE INFORMATION, PLEASE CONTACT:

**ANDREW HAWKINS | 904.345.2022**

Senior Vice President

[Andrew.Hawkins@foundrycommercial.com](mailto:Andrew.Hawkins@foundrycommercial.com)

Licensed Real Estate Broker

Although the information contained herein was provided by sources believed to be reliable, Foundry Commercial makes no representation, expressed or implied, as to its accuracy and said information is subject to errors, omissions or changes.

**FOUNDRY**  
COMMERCIAL

[foundrycommercial.com](http://foundrycommercial.com)