



LARGO, FL

INDUSTRIAL SPACE AVAILABLE FOR SUBLEASE

7225 BRYAN DAIRY RD.

±6,085 RSF AVAILABLE FOR SUBLEASE

±6,085 RSF AVAILABLE FOR SUBLEASE

LARGO, FL

INDUSTRIAL SPACE AVAILABLE FOR SUBLEASE

PROPERTY FEATURES

- Climate controlled warehouse
- 2/1,000 parking ratio
- 3 Roll-up doors
- 2 Dock Wells
- 1 Edge of Dock
- Lease expiration: 2/1/2028



FOR MORE INFORMATION, PLEASE CONTACT:

CAITLIN QUINLAN | 540.550.2549

Senior Associate

Caitlin.Quinlan@foundrycommercial.com

Licensed Real Estate Broker

Although the information contained herein was provided by sources believed to be reliable, Foundry Commercial makes no representation, expressed or implied, as to its accuracy and said information is subject to errors, omissions or changes.

FOUNDRY
COMMERCIAL

foundrycommercial.com

AVAILABLE FOR SUBLEASE

LOCATION OVERVIEW

TRAVEL DISTANCES

Bryan Dairy Rd.	0.1 Miles
U.S. Highway 19	1.8 Miles
I-275	6.3 Miles
Downtown Clearwater	10.2 Miles
Downtown St. Pete	13.6 Miles
Downtown Tampa	20.0 Miles
St. Pete-Clearwater International Airport	5.3 Miles
Tampa International Airport	18.1 Miles

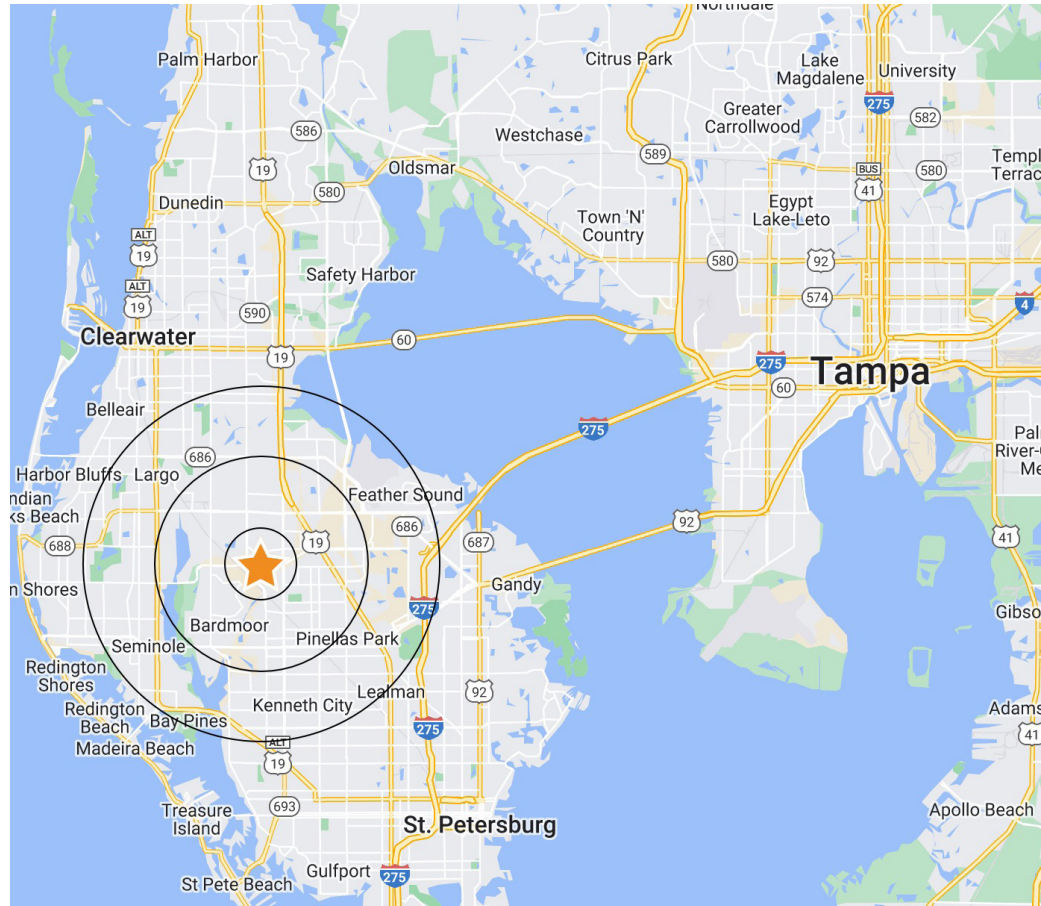

SURROUNDING DEMOGRAPHICS

	1 MILE	3 MILES	5 MILES
Total Population	8,036	102,553	268,044
Total Households	3,546	43,637	122,447
Median Age	46.9	46.4	48.2
Median HH Income	\$78,697	\$70,653	\$66,995

FOR MORE INFORMATION, PLEASE CONTACT:

CAITLIN QUINLAN | 540.550.2549

Senior Associate

Caitlin.Quinlan@foundrycommercial.com

Licensed Real Estate Broker



LARGO, FL

±6,085 RSF AVAILABLE FOR SUBLEASE

AVAILABLE FOR SUBLEASE

FLOOR PLAN

7225 BRYAN DAIRY RD.

6,085 SF AVAILABLE

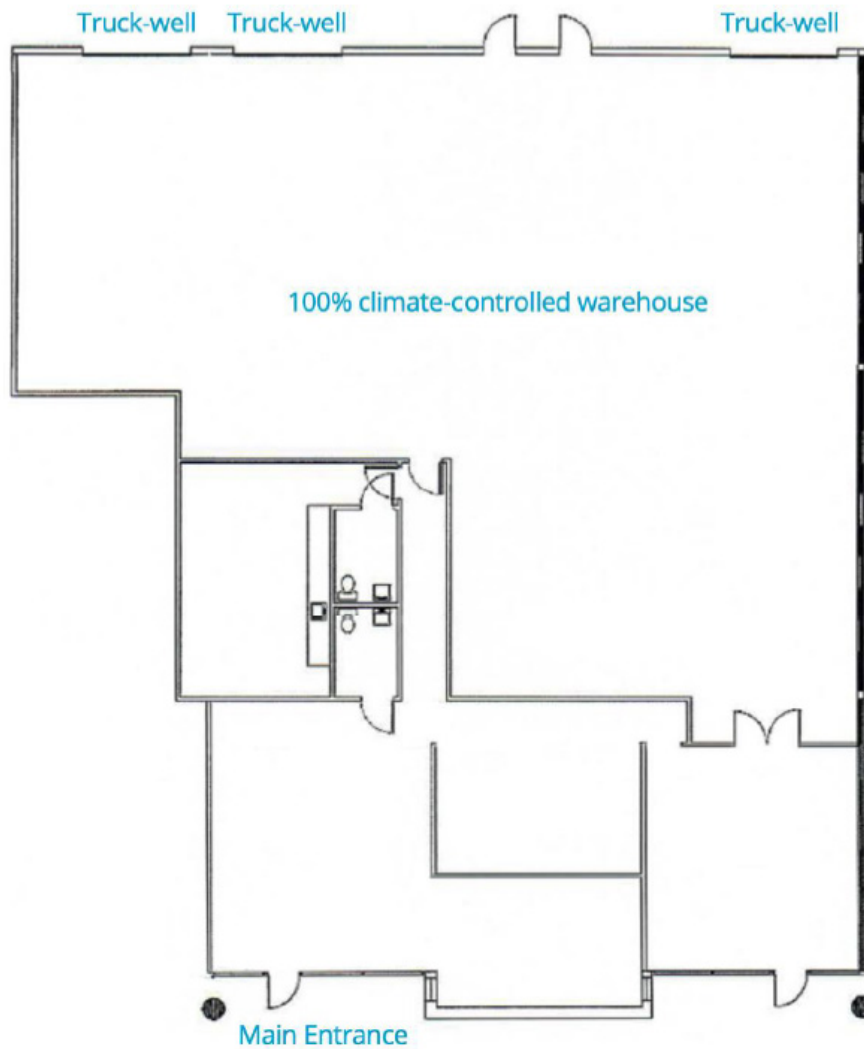

FOR MORE INFORMATION, PLEASE CONTACT:

CAITLIN QUINLAN | 540.550.2549

Senior Associate

Caitlin.Quinlan@foundrycommercial.com

Licensed Real Estate Broker

Although the information contained herein was provided by sources believed to be reliable, Foundry Commercial makes no representation, expressed or implied, as to its accuracy and said information is subject to errors, omissions or changes.

FOUNDRY
COMMERCIAL

foundrycommercial.com